



SPARES FOR ROYAL ENFIELD AND AMAL

EMAIL: info@hitchcocksmotorcycles.com

WEB: www.hitchcocksmotorcycles.com

HITCHCOCK'S MOTORCYCLES LTD
ROSEMARY COURT
OLDWICH LANE WEST
CHADWICK END
SOLIHULL
B93 0EY ENGLAND

TELEPHONE: 01564 783192

Fixing Instructions for: 650 Twin Side Carriers - Part Number 92848A

You will have received 2 sets of the following:



You will require the following tools:

4mm & 6mm Allen Key
10mm, 12mm, & 13mm Spanners

Instructions:

Before attempting to fit the racks to your bike, it will be necessary to install the various fixings and attachment arms to the pannier frames – Shown is the left hand pannier frame viewed from the outside. The same must be done for the right hand side.

Attach the lock clip to the outside of the pannier frame with the 2 short screws to the plate here. The hollow part of the lock clip is on the underside.

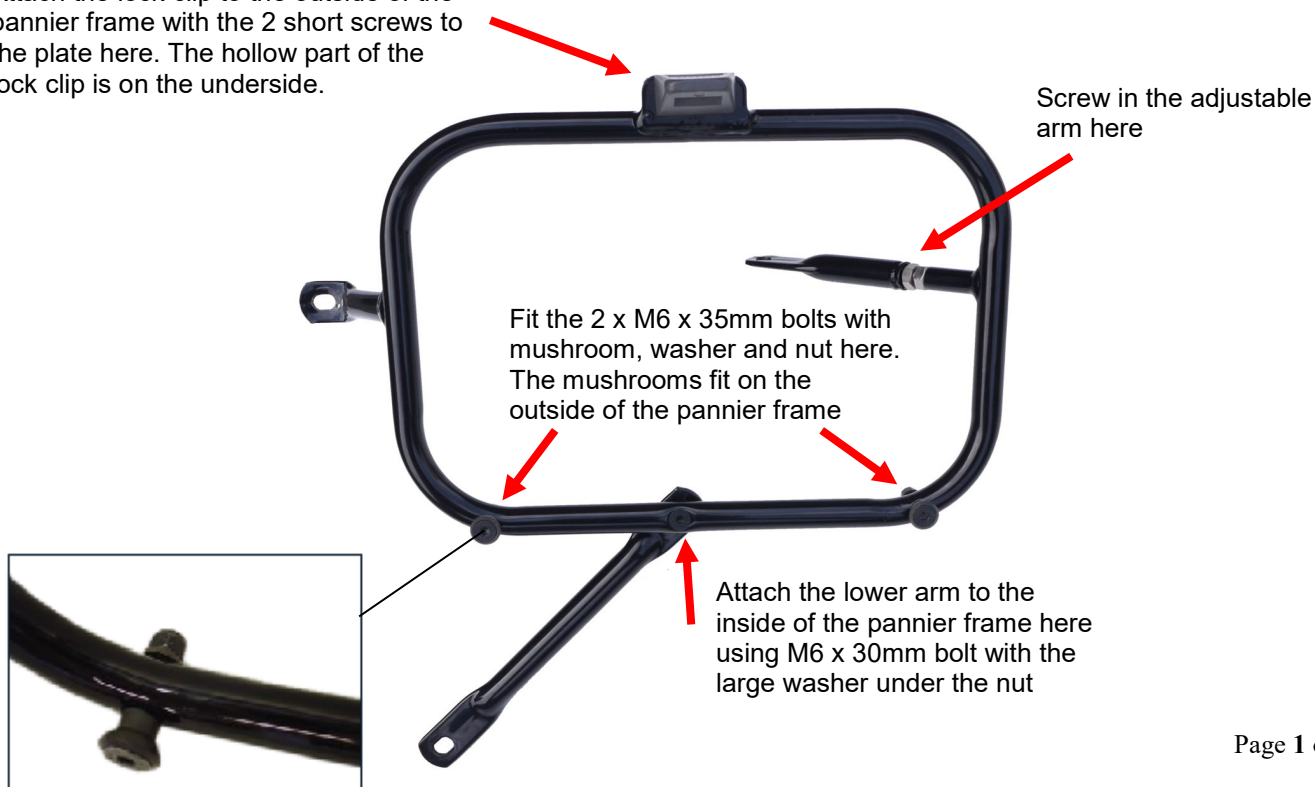



Loosely fit the top front fixing of the pannier frame mount to the rear shock absorber top bolt using the existing bolt. *Please note: The rear shock absorber top bolt can be loctited in at the factory and it is important to use a well-fitting Allen Key to prevent rounding the head of the bolt.*

Loosely attach the bottom arm to the silencer bolt immediately behind the rear pillion footrest using the existing bolt.



The rear adjustable arm attaches to the rear most hole on the underside of the seat frame where the grab rail is bolted. Use the existing bolts, but do not tighten yet. *The pannier frames will fit with or without the grab rail.*

Using the adjustable rear arm and the slots in the other arms, carefully align both pannier frames before tightening all fixings.

Fitting the pannier boxes to the pannier frames



The pannier box fits onto the rack in 3 positions:



Drop the pannier box down onto the lower mushrooms then push the upper part of the pannier box towards the top lock clip. It should click into position.