



SPARES FOR ROYAL ENFIELD AND AMAL

EMAIL: info@hitchcocksmotorcycles.com
WEB: www.hitchcocksmotorcycles.com

HITCHCOCK'S MOTORCYCLES LTD
ROSEMARY COURT
OLDWICH LANE WEST
CHADWICK END
SOLIHULL
B93 0EY ENGLAND

TELEPHONE: 01564 783 192
FAX: 01564 783 313

Steering Damper for Continental GT 535 Part number 92611

The parts included in the kit (note: a number of items will be pre-assembled to form the sub assembly of the damper unit).

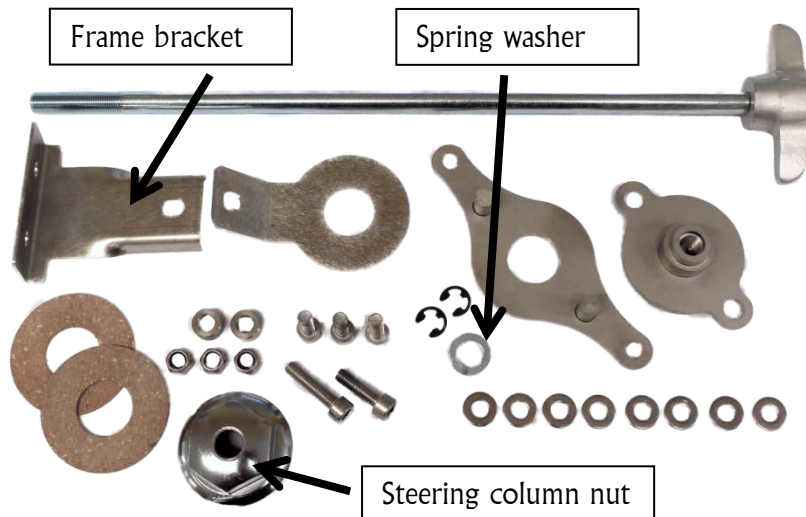

1. Fit the bracket of the sub assembly of damper unit to the lower fork yoke with the supplied M6 socket head screws – note position of spacers.

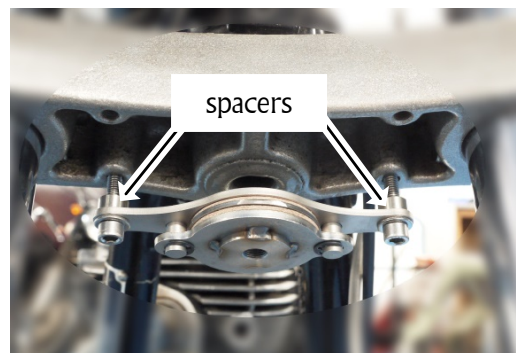

2. Loosely fit the frame bracket to the frame with the supplied M6 socket head screws, washers and M6 nuts. Using the supplied M6 button head screw, washers and M6 nut secure these two brackets together. So they are flush. It may be necessary to alter the angles of the brackets. Fully tighten all fixings.



3. Replace steering column chrome nut with newly supplied steering column nut. Fit spring washer to damper rod and insert damper rod through column – screw damper rod until required damping effect is achieved.

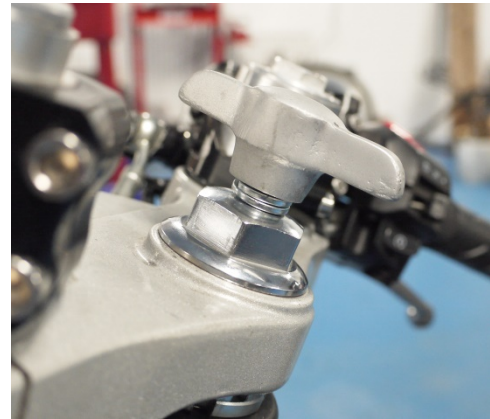
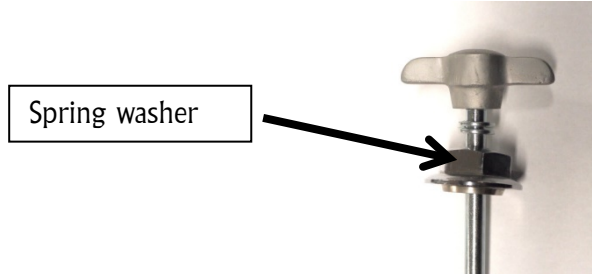

Steering damper for GT Continental – damper sub assembly

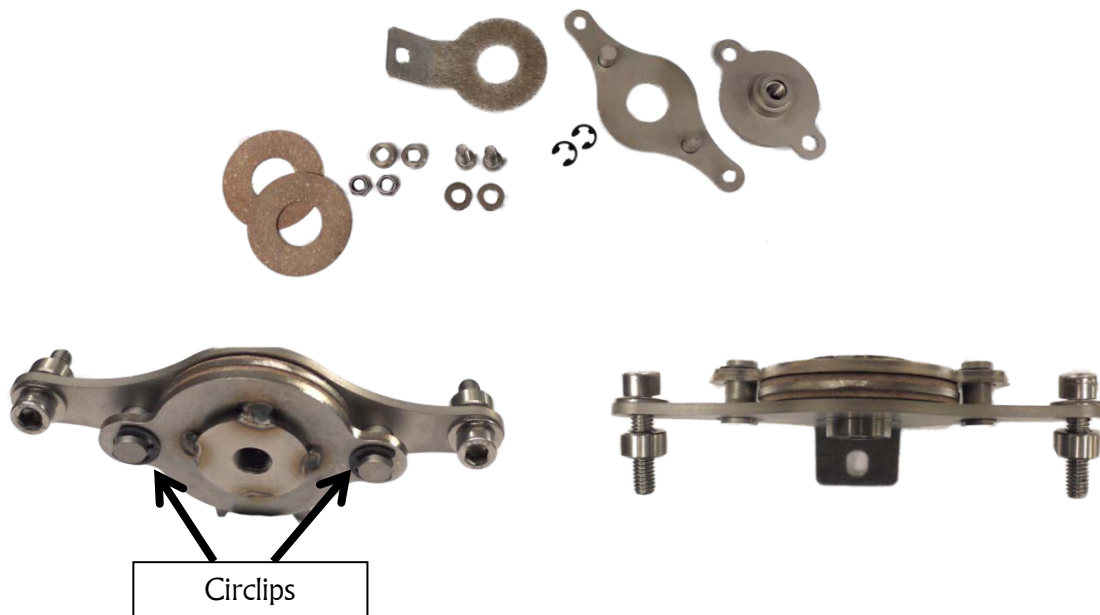

NOTE: The base plate must be positioned in relation to the angled mounting plate in the orientation shown below. The base plate is **not symmetrical**.

